

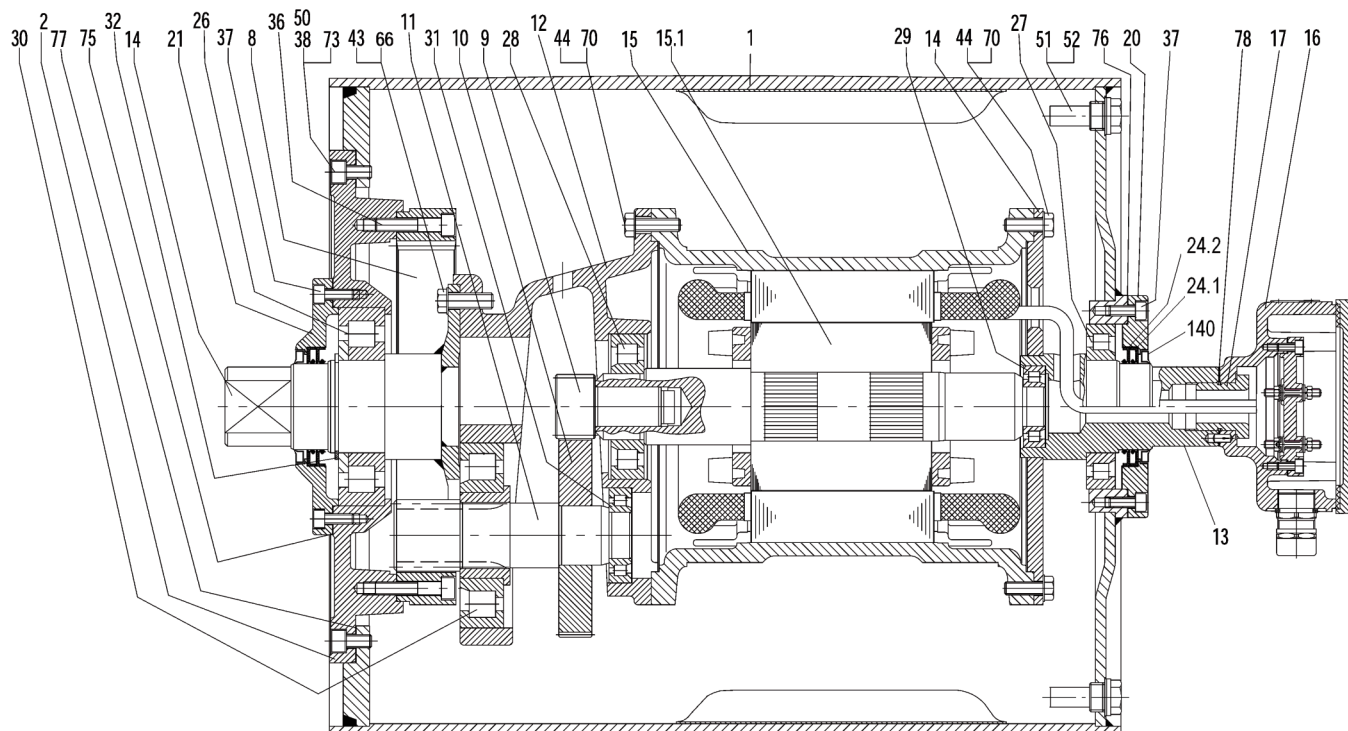

# Motorized Pulley 500L, Ø 19.72 in. (501 mm)

## Spare parts list and sectional drawings

Pos.	Description	Pos.	Description	Pos.	Description
1	Shell	27	Bearing	90	Backstop
2	End housing with geared rim	28	Bearing	91	Electromagnetic brake
8	Geared rim	29	Bearing	93	Retaining ring
9	Rotor pinion	30	Bearing	94	Hexagon head screw
10	Input wheel	31	Bearing	99	Waved spring washer
11	Output pinion	32	Retaining ring	101	Key
12	Gear box ñ cast aluminum	36	Hexagon socket screw	104	Distance washer
13	Front shaft	37	Hexagon socket screw	120	Labyrinth cover
13.1	Front shaft (ss option)	38	Hexagon socket screw	121	Fixing bolt
14	Rear shaft	43	Hexagon screw	122	O-ring
14.1	Rear shaft (ss option)	44	Hexagon screw	123	Grease nipple
15	Stator complete	45	Hexagon screw	140	Deflection seal (future)
15.1	Rotor	50	Waved spring washer	180	Intermediate pinion shaft
16	Terminal box complete	51	Gasket	181	Intermediate pinion
17	Nipple	52	Magnetic oil plug	182	Distance washer
20	Cover ñ front side	53	Distance washer	183	Distance washer
20.1	Cover with labyrinth groove	66	Waved spring washer	184	Roller bearing
21	Cover ñ rear side	67	Waved spring washer	185	Roller bearing
21.1	Cover with labyrinth groove	70	Waved spring washer	186	Key
23	Rear flange	73	Set screw	187	Key
24.1	Shaft oil seal outer	75	Gasket	188	Retaining ring
24.2	Shaft oil seal inner	76	Gasket	190	Retaining ring
24.3	Shaft oil seal outer (lab option)	77	Gasket	191	Retaining ring
24.4	Shaft oil seal inner (lab option)	78	Gasket	194	Set screw
26	Bearing	85	Intermediate flange	196	Key
				197	Retaining ring





# Motorized Pulley 500M, Ø 19.72 in. (501 mm)

## Spare parts list and sectional drawings

Pos.	Description	Pos.	Description	Pos.	Description
1	Shell	26	Bearing	90	Backstop
2	End housing with geared rim	27	Bearing	91	Electromagnetic brake
3	End housing	28	Bearing	93	Retaining ring
8	Geared rim	29	Bearing	94	Hexagon head screw
9	Rotor pinion	30	Bearing	99	Waved spring washer
10	Input wheel	31	Bearing	100	Key
11	Output pinion	32	Retaining ring	104	Distance washer
12	Gear box ñ cast iron	36	Hexagon socket screw	120	Labyrinth cover
13	Front shaft	37	Hexagon socket screw	121	Fixing bolt
13.1	Front shaft (ss option)	38	Hexagon socket screw	122	O-ring
14	Rear shaft	43	Hexagon head screw	123	Grease nipple
14.1	Rear shaft (ss option)	44	Hexagon head screw	140	Deflection seal (future)
15	Stator complete	45	Hexagon head screw	180	Intermediate pinion shaft
15.1	Rotor	50	Waved spring washer	181	Intermediate pinion
16	Terminal box complete	51	Gasket	182	Distance washer
17	Nipple	52	Magnetic oil plug	183	Distance washer
20	Cover ñ front side	53	Distance washer	184	Roller bearing
20.1	Cover with labyrinth groove	66	Waved spring washer	185	Roller bearing
21	Cover ñ rear side	70	Waved spring washer	186	Key
21.1	Cover with labyrinth groove	73	Set screw	187	Key
23	Rear flange	75	Gasket	188	Retaining ring
24.1	Shaft oil seal outer	76	Gasket	191	Retaining ring
24.2	Shaft oil seal inner	77	Gasket	194	Set screw
24.3	Shaft oil seal outer (lab option)	78	Gasket	196	Key
24.4	Shaft oil seal inner (lab option)	85	Intermediate flange	197	Retaining ring

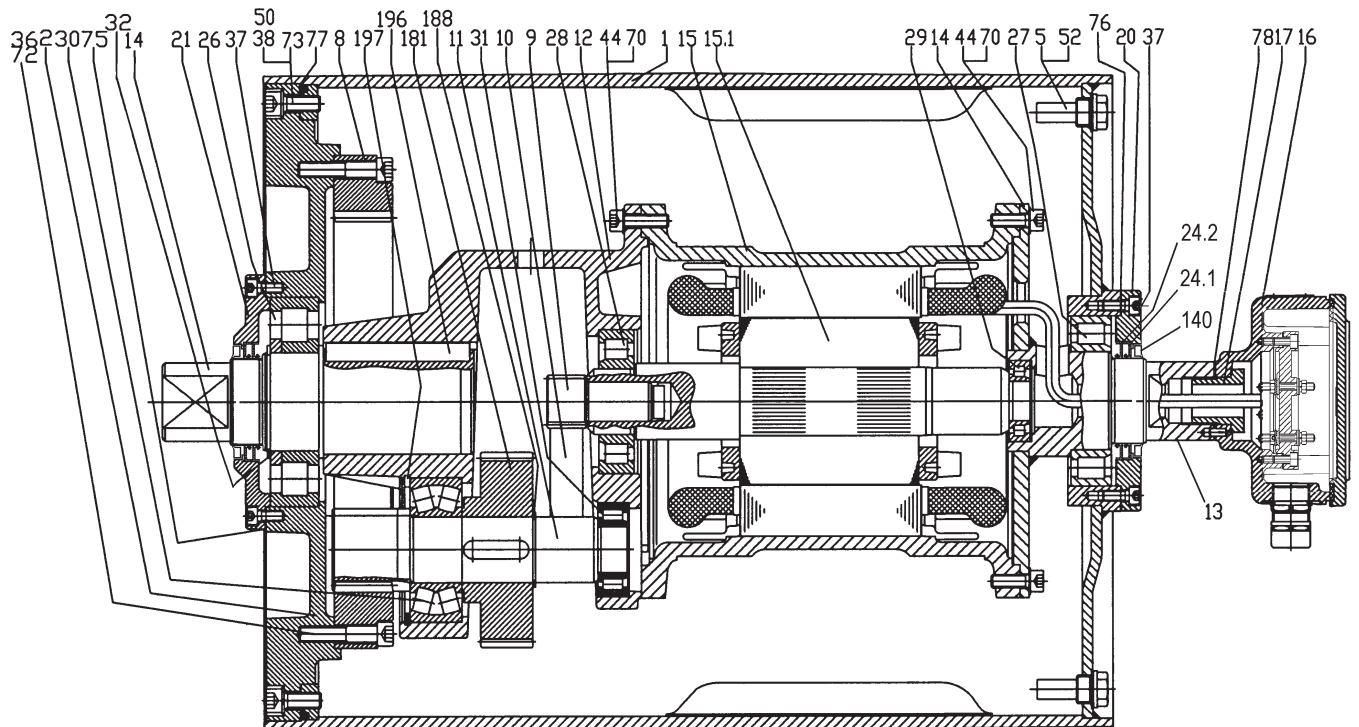



# Motorized Pulley 500H, Ø 19.72 in. (501 mm)

## Spare parts list and sectional drawings

Pos.	Description	Pos.	Description	Pos.	Description
1	Shell	24.4	Shaft oil seal inner (lab option)	77	Gasket
4	End housing with geared rim	26	Bearing	78	Gasket
8	Geared rim	27	Bearing	79	Holding plate
9	Rotor pinion	30	Bearing	85	Motor flange for backstop/brake
10	Input wheel	31	Bearing	90	Backstop
11	Output pinion	32	Retaining ring	90.1	Backstop housing
12	Gear box including rear shaft	33	Retaining ring	90.2	Backstop cover
13	Front shaft	34	Retaining ring	93	Backstop retaining ring
14	Rear shaft	35	Retaining ring	94	Backstop hex head screw
15	Stator complete	37	Hexagon socket screw	99	Backstop spring washer
15.1	Rotor	38	Hexagon socket screw	101	Backstop key
16	Terminal box complete	42	Hexagon head screw	123	Grease nipple
17	Nipple	44	Hexagon head screw	130	Brake shaft
18	Mounting brackets rear side	45	Hexagon head screw	131	Mounting bracket bearing cover
18.1	Mounting bracket w/lab rear side	50	Washer	132	Roller bearing
19	Mounting bracket front side	51	Gasket	133	Brake shaft seal
19.1	Mounting brackets w/lab front side	52	Magnetic oil plug	134	Brake shaft seal
20	Cover n front side	58	Spring washer	135	Retaining ring
20.1	Cover with labyrinth groove	68	Key	136	Bolts - bearing cover
21	Cover n rear side	69	Gib key	137	Spring lock washer
22.1	Cover with labyrinth groove	70	Waved spring washer	138	Key
23	Rear flange	72	Grooved pin	139	Retaining ring
24.1	Shaft oil seal outer	73	Set screw	140	Key
24.2	Shaft oil seal inner	75	Gasket	140.1	Deflection seal (future)
24.3	Shaft oil seal outer (lab option)	76	Gasket		

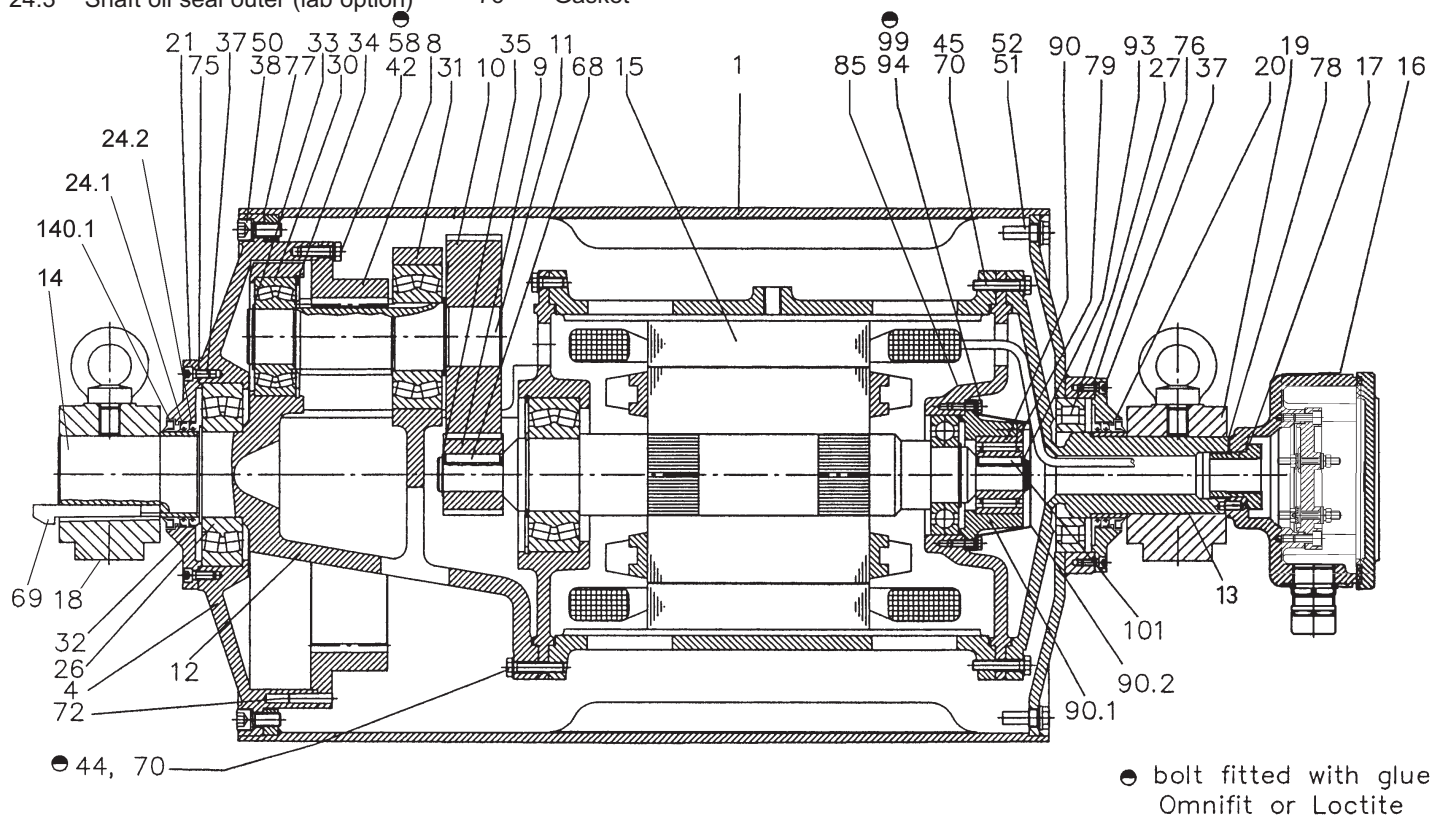

Cross sectional drawing shows optional backstop.



# **Motorized Pulley 500L & 500M, Ø 19.72 in. (501 mm)** **Sectional drawings (See parts list on pages 54 & 55.)**

Intermediate Shaft (valid for 500M)

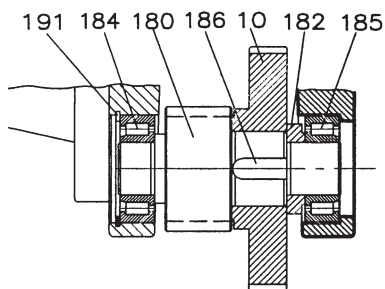

Labyrinth Option

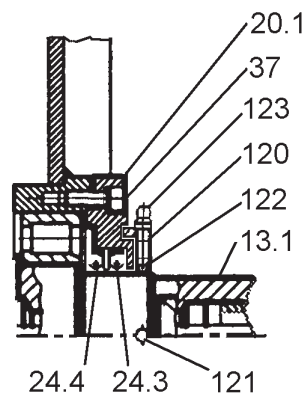

Backstop Option

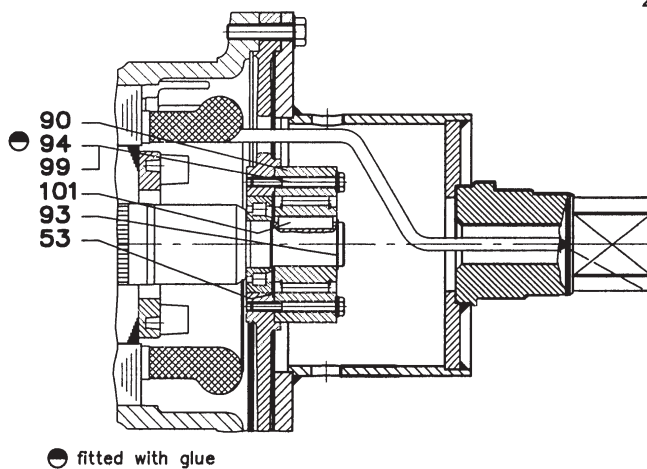

Electromagnetic Brake Option

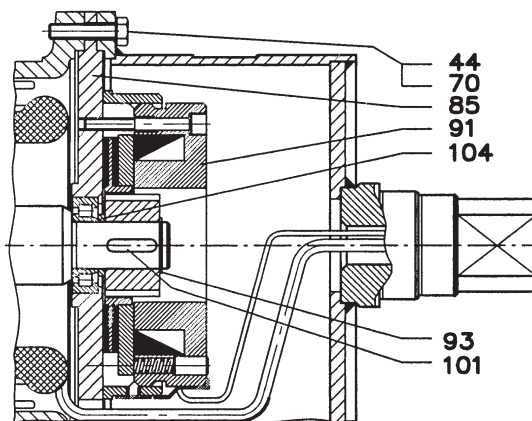



## Motorized Pulley 500H, Ø 19.72 in. (501 mm)

Sectional drawings (See parts list on page 56.)

Labyrinth Seal Option

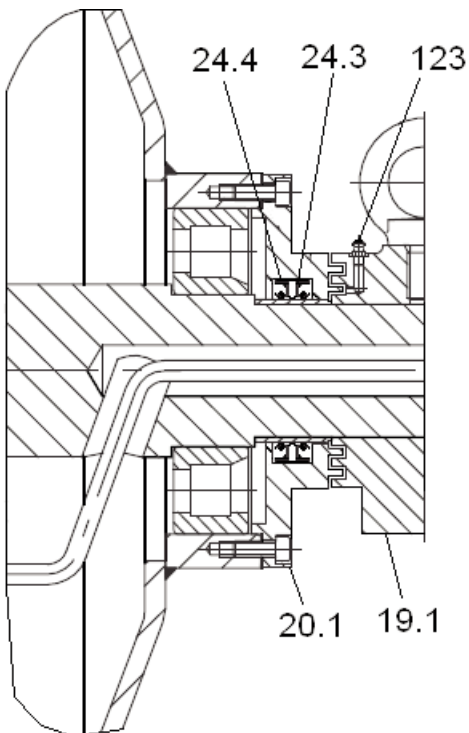

External Brake Shaft Option

